

MODEL 875

MODEL 872

TEA-MASTER SERIES POST-MIX ICED TEA DISPENSERS FOR USE WITH ONE-GALLON JUG OR BAG-IN-BOX



MODEL 875

The Tea-Master Series utilizes a venturi valve to mix the tea syrup with the water. A built-in water pressure regulator ensures the proper amount of syrup is being mixed with the proper amount of water. This built-in pressure regulator is factory adjusted for a static pressure of 18 pounds.

The Model 875 is also available in a two- flavor model.



MODEL 872



KARMA Inc.

P.O. Box 433
Watertown, WI 53094 USA
920-261-1424
800-558-9565
Fax 920-261-3302

Internet Web Page
<http://www.karma-inc.com>
E-mail - karma@karma-inc.com

SPECIFICATIONS

Plumbing: ¼" flared copper or flex hose. 25 PSI minimum

Model 875

Dimensions: 9½" X 8½"d X 26½" h

Weight: 15 lbs Shipping 30 lbs

Model 872

Dimensions: 9½" X 18"d X 23¼" h

(depth includes faucet/water connection)

Weight: 20 lbs Shipping 30 lbs

Agency: NSF Approved
Standard (18)

Installation

1. Carefully remove the dispenser from the shipping carton.
2. **Before attaching the waterline to the dispenser, flush the waterline to remove any foreign particles that may be in the line.**

NOTE: It is advisable to use a lime, scale, sediment, taste and odor purification charcoal water filter where water quality is a concern.

3. Using the ¼" flare nut connect a ¼" flared flexible or copper waterline to the male fitting on the back of the dispenser.
4. Turn on the water source to the dispenser.
5. Turn the yellow handle to the ON position to allow water to flow through the urn.



Product Loading

1. Open the BIB along the perforated edges. Pull out the dispensing spout. Place the spout in the cardboard opening.
2. Remove the cap from the spout.
3. Connect the QCD fitting to the dispensing spout.

Note: THE FITMENT MUST BE PUSHED ALL THE WAY OUT SO THAT THE WORD OUT IS EXPOSED ON THE TOP OF THE FITMENT.

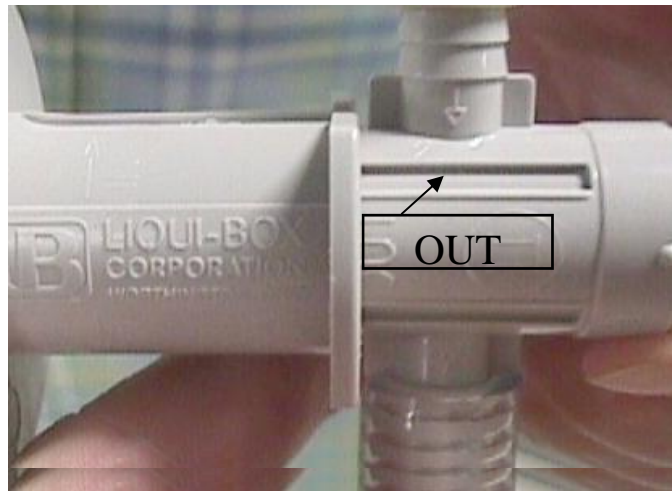

4. Place the QCD into the neck of the dispensing spout at the ridge as shown on the illustration.



5. Press QCD towards the dispensing spout until it is flush with the collar of the QCD.



6. The BIB box should lie horizontally
 - Avoid loops in the product line
 - Use the minimum amount of product line required.
 - Check for air bubbles in the product line to trouble shoot for priming

PRIME SYSTEM

7. After the BIB has been connected to the QCD valve dispense approximately 12 ounces of product.
8. Dispense another 8 ounces of product and sample for taste.

NOTE: Be sure there are no air bubbles in the product line.

Gallon Jug Model 875

1. Remove the cover. Lift the product hose and dip tube out of the dispenser. Remove the bottle cap from the concentrate jug.



2. Place the dip tube into the concentrate. Tighten the white bottle cap on the dip tube to the concentrate jug. Place the gallon jug of concentrate into the dispenser.



Note: The product hose will wrap loosely around the bottom of the concentrate jug. **CHECK FOR ANY KINKS IN THE PRODUCT HOSE.**

3. Place a glass under the faucet.
4. **PULL THE FAUCET HANDLE ALL THE WAY DOWN.** Hold the handle down until the glass begins to fill with tea.
5. Release the faucet.
6. Dispense a second glass and sample for taste. If an adjustment is necessary refer to Drink Richer/Leaner Adjustment Section

Taste Calibration

Note: There is an adjustment rod for each dispense head. The dispenser has been factory adjusted to the proper strength range.

To fine tune the drink strength:

1. Tilt the dispenser backwards.
Reach underneath and grasp the proper adjustment rod very slightly (1/8th turn at a time).

Turn the adjustment rod as shown:

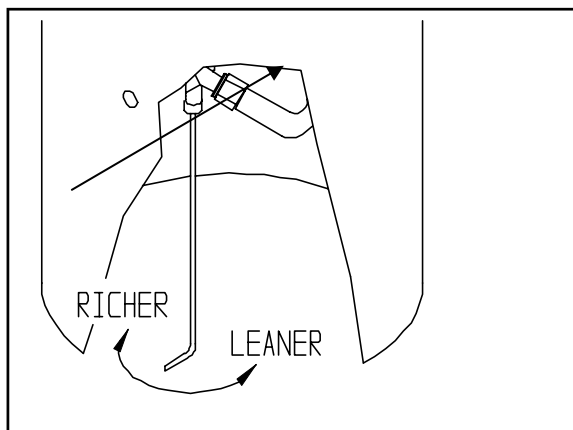

5. Disconnect bag from QCD and connect a new BIB to fitment.

Clean Dispenser and Faucet

1. Turn off water source to dispenser



2. Open and close the faucet handle to relieve system of water.



Cleaning Instructions

(to be done when changing box or gallon jug)

Clean Syrup Line

1. Remove bag from box
2. Cut away the majority of the bag
3. Place bag and QCD in container of hot water
4. Hold faucet handle down until clear water runs from faucet.
(This cleans the product line and the fitment)

3. Unscrew the faucet/handle cap assembly from the faucet.

Cap

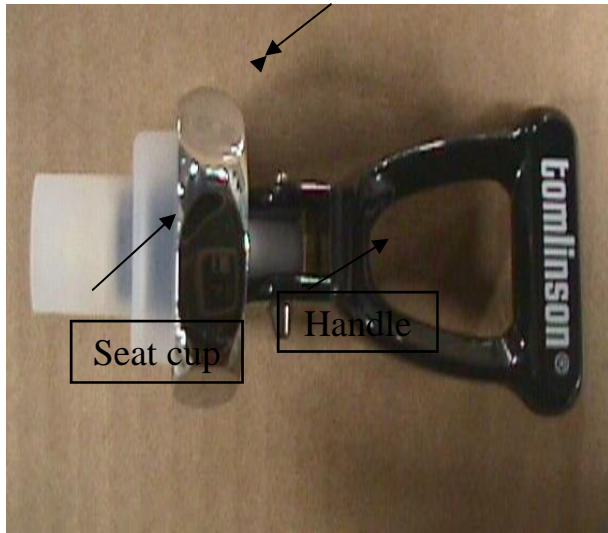

4. Wipe inside of faucet body with a mild dishwashing soap and hot water.
5. Do the same to handle, cap, and seat cup.
6. Re-install assembly to faucet body, taking care not to cross thread when installing. Finger tight is adequate.
7. Turn water source to on position.
8. Dispense approximately 12 ounces

Gallon Jug

1. Remove the product container.
2. Replace the product container with a container of very hot water. (at least 32 ounces at 140°)
3. Hold the faucet down until container is empty.
4. Refill the container with lukewarm water about 110° and one tablespoon of a mild dish soap such as Ivory. Follow step 3.
5. Repeat steps 2 and 3 until there is no evidence of soap.
6. Reload the system with concentrate. Hold the faucet down and dispense an eight ounce drink to prime the system.

WEEKLY SANITIZING

BAG-IN-BOX

1. Remove the quick disconnect from Bag-in-Box (BIB).
2. Shut off water supply valve on the back of the dispenser.
3. Open and close faucet handle to relieve system of water.
4. Unscrew the faucet handle/cap assembly from faucet.
5. Wash the faucet/cap/seat cup assembly in a mild dishwashing soap and warm water.
6. Re-install assembly to faucet body taking care not to cross-thread when installing. Finger tight is adequate.
7. Turn water supply on.
8. Mix one ounce of San-I-Queen sanitizer or the equivalent which will equal 650 parts per million of chlorine when mixed with one gallon of 100° warm water.
9. Open the quick disconnect and place into the one gallon vessel of sanitizing solution.
10. Place a large vessel under the faucet. Lock the faucet open until the container of sanitizing solution is empty. (DO NOT FLUSH UNTIL THE FOLLOWING MORNING.)
11. Flush by reloading the dispenser with concentrate. Lock the faucet handle down until the tea is dispensed from the faucet. Dispense three eight ounce servings and discard.

Gallon Jug

1. Remove product container.
2. Replace the product container with the following: Mix one ounce of San-I-Queen sanitizer or the equivalent which will equal 650 parts per million of chlorine when mixed with one gallon of 100° warm water.

3. Hold the faucet down until container is empty.
(DO NOT FLUSH UNTIL THE FOLLOWING MORNING)
4. Flush by reloading the dispenser with concentrate. Reload the gallon jug. Hold the faucet down and dispense three eight ounces servings and discard.

<h2>Do's and Don'ts</h2>

- | OPERATION |
|--|
| <ol style="list-style-type: none">1. Do fully activate faucet handle when dispensing drinks.2. Do clean & sanitize dispensing assembly monthly.3. Do keep dispenser primed with concentrate at all times.4. Do reload immediately when out of concentrate.5. Do flush and clean lines regularly.6. Don't forget to clean & sanitize faucet seat cup7. Do follow all cleaning and sanitizing procedures, remove and store concentrate if urn will not be used for an extended period of time; ie: more than two days. |

- | INSTALLATION |
|---|
| <ol style="list-style-type: none">1. Do connect dispenser to a filtered waterline.2. Do flush filters before connecting to dispenser.3. Do sample finished drink before making adjustments.4. Do make very slight drink adjustments then sample.5. Don't forget to flush filters before installation.6. Don't make any pressure regulator adjustments on urn. (Do NOT attempt to adjust the urn regulator. If a regulator adjustment is required call the factory at 1-800-558-9565. The adjustment should be made by a qualified service technician.)7. Don't forget to get sample approval from customer. |

REPLACEMENT PARTS LIST

PART		
ITEM	NUMBER	DESCRIPTION
*	14317	COVER
*	14109	DRIP TRAY
*	14110	INSERT
*	7606	DRIP TRAY/INSERT (2 FLAVOR)

FAUCET

*	3949	COMPLETE FAUCET
1	5899	HANDLE
2	6608	BONNET
3	4354	SPRING
4	8554	SPRING COVER
5	4353	PLUNGER
5A	4355	DRIFT PIN
6	6609	SEAT CLIP
7	6610	BODY
8	4242	NUT
9	1125	C WASHER
10	6417	SHANK

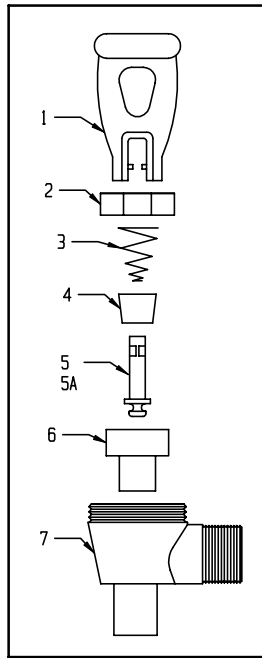

VENTURI/CHECK VALVE

*	6215	COMPLETE
11	5535	ADAPTER
12	4211	O RING
13	6181	DISPENSE HEAD
14	6180	LOCKING CLIP
15	3066	ELBOW
16	3343	O RING
17	5508	SPRING
18	5507	BALL
19	5506	SLEEVE
20	5505	O RING
21	5504	BODY
23	*4163	BULK TUBING 8"
24	14568	ADJUSTMENT SCREW AND O RING (2794)

PRESSURE REGULATOR ASSEMBLY

*	6222	COMPLETE
25	6217	WATERLINE
26	3066	ELBOW
27	6220	SUPPLY VALVE
28	3311	NIPPLE
29	2948	PRESSURE REGULATOR
30	6211	CHECK VALVE
31	6214	REGULATOR PLATE
32	2179	UNION FITTING 1/4 MFLR
33	7641	INLINE FILTER

BOTTOM COVER

*	6732	BOTTOM COVER (435 SCREW) 2
*	1825	STOP/SPACER
*	460	SCREW (1)

MISCELLANEOUS

*	4731	PRESSURE REGULATOR REPAIR KIT
*	*4163	PRODUCT TUBING (BAG IN BOX) 36"
*	6042	DIP TUBE
*	4443	CAP
*		ORDER 4163 TUBING IN REQUIRED INCHES

MODEL 872

ITEM	NUMBER	DESCRIPTION
*	14410	COVER
*	14621	DRIP TRAY - STAINLESS STEEL
*	14635	INSERT - STAINLESS STEEL
*	2617	STRAIGHT FITTING
*	8797	"T" FITTING

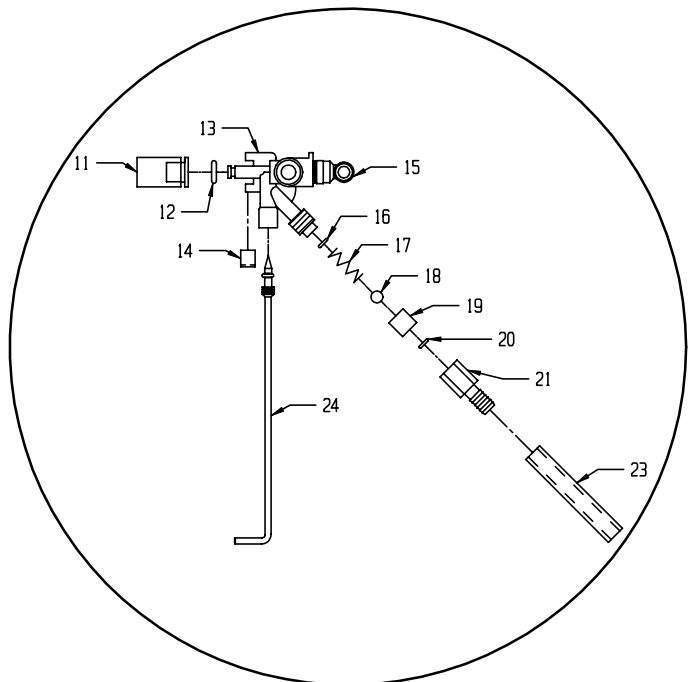
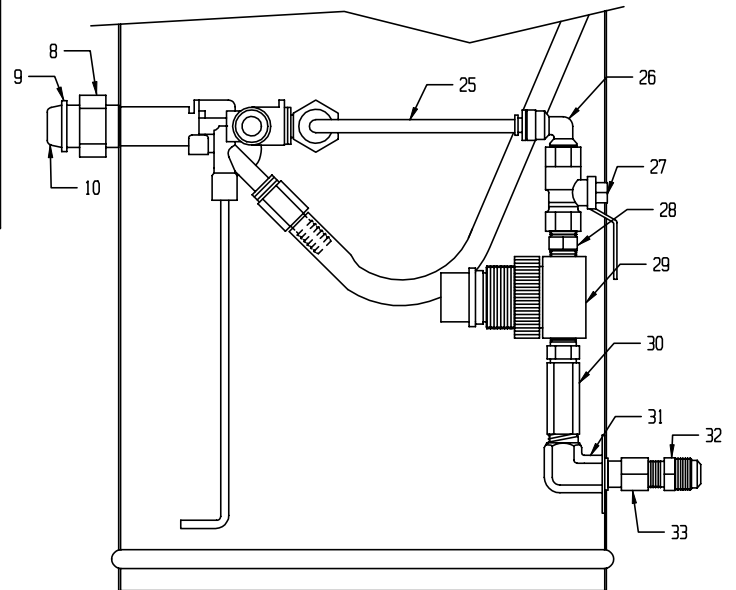

TROUBLESHOOTING

PROBLEM	CAUSE	CORRECTIVE ACTION
Difficulty priming dispenser.	1. Product adjustment screw turned in too far.	1. Turn adjustment rod ¼ turn clockwise (richer/leaner adjustment). 2. Regulator adjustment is required. Call the factory for assistance.
Pulled faucet handle, no product, no water.	1. Water supply not on.	1. Turn water supply on.
Drink too foamy or bubbly	1. Concentrate BIB empty. 2. Hole or tear in product tubing prior to BIB connection. 3. Loose syrup line connection.	1. Load new BIB 2. Replace tubing 3. Check syrup line connections from check valve.
Drink inconsistent	1. Waterline pressure dropping below machine's preset pressure regulator adjustment.	2. Regulator adjustment is required. Call the factory for assistance.
Water only—no product	1. Concentrate BIB empty. 2. Product hose clogged. 3. Product hose kinked. 4. Check valve not seating. 5. Adjustment screw in too far.	1. Load new BIB. 2. Clean product hose or replace. 3. Check for kinks. 4. Disassemble and clean check valve. 5. Turn adjustment screw out using adjustment rod.
Faucet dripping	1. Foreign particles on seat cup. 2. Damaged seat cup. 3. Pressure set too high.	1. Follow seat cup cleaning. 2. Replace seat cup. 3. Regulator adjustment is required. Call the factory for assistance.
Drink too weak	1. Adjustment screw in too far. 2. Check valve not seating.	1. Turn adjustment screw out Richer/Leaner adjustment. 2. Disassemble and clean check valve.
Air bubbles in syrup	1. Loose tubing connection at QCD or at check valve barb. 2. Worn O-ring on QCD plunger. 3. Air in bag.	1. Ensure tubing is slid all the way on to the QCD and check valve barb. 2. Replace QCD. 3. Stand BIB upright, open faucet handle and prime syrup line until all air bubbles are gone.